



07030

Please read the following instructions and warnings carefully.  
Keep this instruction manual for future reference.

Tools required: Two Phillips head screwdrivers (not included)

**For Technical Support Call 1-800-268-6237 or  
E-Mail at [customerservice@summerinfant.com](mailto:customerservice@summerinfant.com)**

For use with children from birth and up.

**! WARNING:**

Adult assembly required. Keep small parts away from children when assembling.

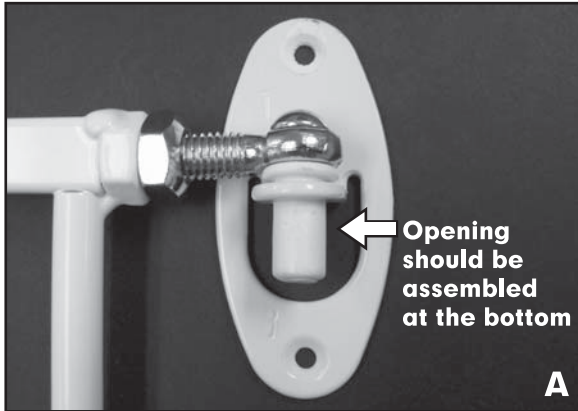

### METAL UPPER HINGE

You will notice that the “plastic” upper hinge image in the instruction sheets is slightly different than the “metal” upper hinge you received. Please note that the new metal upper hinge assembles the same as the plastic upper hinge.

**CAUTION:** Please note the correct assembly orientation of the metal upper hinge in figure A. Make sure the opening in the hinge (see figure A) is at the bottom when assembling the hinge.

## SURE AND SECURE™ EXTRA TALL TOP-OF-STAIRS GATE WITH ALARM METAL HINGE

Thank you for buying the Sure and Secure™ Extra Tall Top-of-Stairs Gate from Summer Infant. This slip sheet provides instructions on how to install the metal hinge.

**Please read before installing the metal hinge.**

**CAUTION: This product is not a toy. Adult supervision is required. Store away from child’s reach.**

**IMPORTANT! KEEP FOR FUTURE REFERENCE!**

### Summer Infant, Inc.

6 Blackstone Valley Place, Suite 206  
Lincoln, RI 02865 USA 1-800-263-6237

[www.summerinfant.com](http://www.summerinfant.com)

© 2005 Summer Infant, Inc.

Please retain information for  
future reference.

### Summer Infant Europe, LTD.

20 Sparrows Herne  
Bushey, Hertfordshire  
WD23 1FX UK 44 (0)20 8420 4429  
Colors and styles may vary.

**MADE IN CHINA**