

Please read the following instructions and warnings carefully. Keep this instruction manual for future reference.

Tools required: Two Phillips head screwdrivers (not included)

For technical support call 1-800-268-6237 or e-mail customerservice@summerinfant.com

Parents
MAGAZINE™
CHILD + SAFETY

Extra Tall Top-of-Stairs Gate With Alarm Metal Hinge

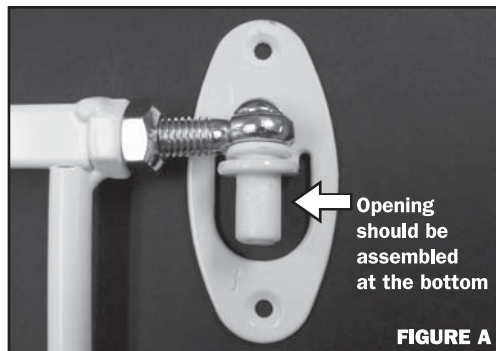

WARNING:

Adult assembly required. Keep small parts away from children when assembling.

For use with children from birth and up.

CAUTION: This product is not a toy. Adult supervision is required. Store away from child's reach.

IMPORTANT! KEEP FOR FUTURE REFERENCE!

Thank you for buying the Extra Tall Top-of-Stairs Gate. This slip sheet provides instructions on how to install the metal hinge.

Please read before installing the metal hinge.

METAL UPPER HINGE

You will notice that the “plastic” upper hinge image in the instruction sheets is slightly different than the “metal” upper hinge you received. Please note that the new metal upper hinge assembles the same as the plastic upper hinge.

CAUTION: Please note the correct assembly orientation of the metal upper hinge in figure A. Make sure the opening in the hinge (see figure A) is at the bottom when assembling the hinge.

© 2005 Gruner + Jahr Publishing, Parents © and Parents Magazine Child + Safety™ are trademarks of Gruner + Jahr Printing and Publishing Co., New York, N.Y. Visit our website: www.parents.com
Manufactured under license by Summer Infant, Inc., Lincoln, RI 02865

Made in China to Summer Infant, Inc., quality specifications

Questions? Comments? Contact us: Parents c/o Summer Infant, Inc. 6 Blackstone Valley Place, Suite 206, Lincoln, RI 02865 USA www.summerinfant.com 1-800-268-6237 Colors and styles may vary.