

Please read the following instructions carefully.  
Keep this instruction manual for future reference.



## Custom-Fit Gate



Thank you for buying the Custom-Fit Gate. This gate expands up to 12 feet without any additional purchase required. The Custom-Fit Gate can fit multiple configurations with ease. This hardware-mount gate helps you create and maintain a secure environment for your child. It has a convenient walk-through door that opens easily in either direction with one hand. The hardware mounts in place for quick installation. It has a child-resistant latch for added security.

Tools required: Phillips head screwdriver.

For technical support call 1-800-268-6237 or e-mail [customerservice@summerinfant.com](mailto:customerservice@summerinfant.com)

### **WARNING:**

This product contains small parts. Adult assembly required. Exercise care when unpacking and assembling product.

For use with children from birth and up.

### **WARNING:**

- To prevent serious injury or death, install gate securely and use according to manufacturer's instructions.
- Never use with a child able to climb over or dislodge the gate or enclosure.
- Never leave child unattended.
- Use only with the lock securely engaged.
- To prevent falls, never use at the top of stairs.
- Do not use if any components are missing or damaged.
- This product is no substitute for proper adult supervision.
- This product contains small parts. Adult assembly is required. Exercise care when unpacking and assembling the product.
- Always close gate behind you.

### **CAUTION:**

KEEP SMALL PARTS OUT OF CHILD'S REACH.

## Features & Components

**3-Panel Gate** For openings 67" to 89" (170 cm to 226 cm) use 2 panels. For openings greater than 89" to 144" (226 cm to 357 cm), use 3 panels.

**Wall Templates**  
(2 on 1 sheet)

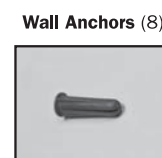
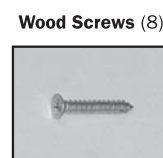
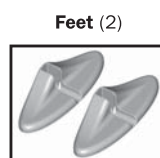
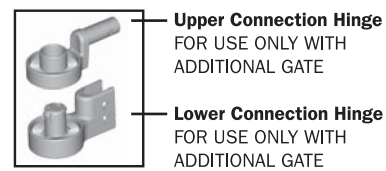
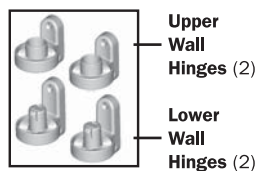
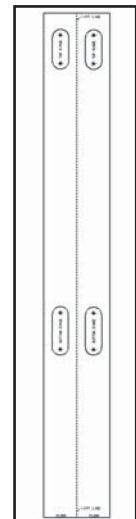
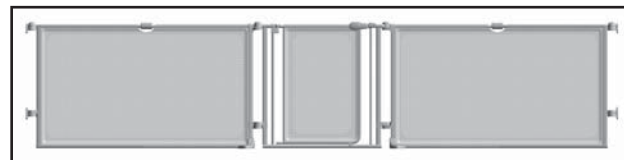

## Set-Up

**Step 1:** Place the bottom of wall template (for the hinges) even with the floor and hold it straight and vertical while you mark the 4 screw-hole positions for the hinges, as shown in Figure A. Screws are provided for mounting the hinges and latches directly to wood. If mounting into wallboard, use the wall anchors and screws provided.



**NOTE:** If wall anchors are needed:

- Drill a hole in the wall (7/32" or 5.5 mm drill bit).
- Insert the wall anchors (included) into the hole and tap gently on the end with a hammer until anchor is flush with wall.

**Step 2:** Mount the lower wall hinge using 2 wood screws in the bottom position, marked in Step 1. Be sure that the hinge post faces up, as shown in Figure B.

**Step 3:** Repeat the mounting procedure with the upper wall hinge at the top position, marked in Step 1. Be sure hinge faces up, as shown in Figure C.



**Step 4:** Repeat Steps 1 to 3 on the wall that the other end of the gate will mount to. For openings 67" to 89" (170 cm to 226 cm), refer to "To Assemble Gate Using Only Two Panels" section.

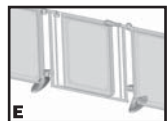

**Step 5:** Unfold gate panels and attach 2 feet as shown in Figures D and E.

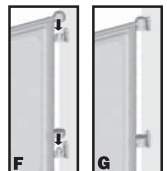

**Step 6:** Attach one end of gate to upper and lower wall hinges as shown. You should hear a snap when mounting the lower hinge (Figures F and G).

**Step 7:** Open the hook-and-loop fabric door with "lock" logo on it to access the expansion handles (Figure H).



**Step 8:** Push button on handle and rotate expansion handle counterclockwise until panel is loose and can expand freely (Figure I).

**Step 9:** Repeat on other panel if necessary, until gate reaches wall mount hinges.

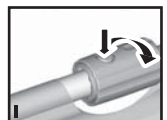

**Step 10:** Repeat the mounting procedure in Step 6 to connect end panel to wall.

**Step 11:** Turn expansion handle(s) clockwise until button engages hole in handle (Figure J).

**Step 12:** Once both panels are securely mounted, turn the 4 hinge knobs clockwise to secure gate (Figure K).

**Step 13:** To open door, slide trigger back and lift door panel up to swing door open in either direction (Figure L).

**Step 14:** To close, lift door panel, align over trigger tab, and push door panel down until it clicks and locks into place (Figure M).

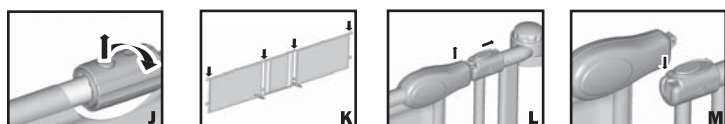

## To Assemble Gate Using Only Two Panels

(For openings 67" to 89" (170 cm to 226 cm))

**Step 1:** Unscrew upper knob on hinge between end panel and door panel (Figure N).



**Step 2:** Remove hinge cover from lower hinge (Figure O).



**Step 3:** Squeeze tabs and separate lower hinges (Figure P).



**Step 4:** Remove entire end panel and retain for future use.

**Step 5:** Refer to steps 4 to 14 in "SET UP" section.

## To Create a Free-Standing Play Yard Using Two Gates

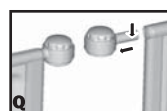

**Step 1:** To remove upper gate hinge on one end panel, press spring-loaded button and pull out (Figure Q).

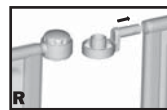

**Step 2:** Replace with upper connection hinge (Figure R).



**Step 3:** Remove the two screws from the lower gate hinge on same panel and replace with lower connection hinge (Figures S and T).

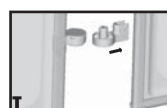

**Step 4:** Repeat steps 1 to 3 on one of the end panels of the second assembled gate.

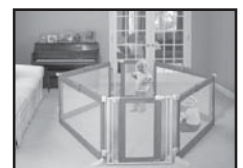
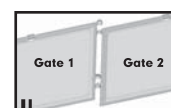

**Step 5:** Attach ends of each gate by lining up the upper and lower hinges on each gate. The lower hinge should snap into place (Figure U).

**Step 6:** Turn the hinge knobs clockwise on each gate to tighten.

## Maintenance

- Regularly check tension knobs and rubber pads to make sure the gate is securely in place.
- Do not use the gate if any components are damaged or missing.
- Wipe surface with a damp cloth or sponge, using mild detergent and warm water.

© 2005 Meredith Corporation. Parents © and Parents Magazine Child + Safety™ are trademarks of Meredith Corporation, New York, NY. Visit our website: [www.parents.com](http://www.parents.com)  
 Manufactured under license by Summer Infant, Inc., Lincoln, RI 02865  
 Made in China to Summer Infant, Inc. quality specifications.  
 Questions? Comments? Contact us:  
 Parents c/o Summer Infant, Inc.  
 6 Blackstone Valley Place, Suite 206  
 Lincoln, RI 02865 USA  
[www.summerinfant.com](http://www.summerinfant.com)  
 1-800-268-6237  
 Colors and styles may vary.